

Standard: EN 13374, class A

Dimensions: Metric

Material: Steel

Manufacturer: SafetyRespect GmbH

Language: English

©SAFETYRESPECT 2023  
August 2023  
Subject to changes.



## Table of Content

General Information.....	3
Components .....	4
Fixing Brackets and Hanging Tubes.....	6
Lift Shaft Door .....	7
Locking Mechanism .....	8
Panel 200/400/500.....	11
Top Panels .....	12
Installation.....	13
Pre-Assembly.....	13
Fixing of the Lower Fixing Brackets .....	14
Insertion of the Door.....	15
Fixing of the Upper Fixing Brackets .....	17
Configurations .....	19
Width 1200 mm.....	19
Width 1400 mm.....	20
Width 1500 mm.....	21
Width 2000 mm.....	22
Width 2200 mm.....	23
Safety.....	24
Maintenance .....	25
Inspection .....	25
Declaration of Conformity.....	26

---

## General Information

The SafetyRespect Lift Shaft Gate offers maximum safety for lift shaft openings in multi-storey construction projects and reliably protects workers and construction site personnel of all kinds from falling.

The system, which is developed and produced at the SafetyRespect factory in Iserlohn, complies with the EN 13374 standard, Class A, and serves both as a full-surface fall arrest solution and as an edge protection system for shaft openings of all kinds. On the one hand, it protects the personnel from accidents and, on the other hand, it ensures easy access to carry out work inside the shaft.

During the development phase, special attention was paid to flexibility of use. Thus, common opening widths can be secured with only a few standard components, with the actual door being the key element. Other intelligent accessories such as the gap covers, which can be placed on all panels to close the "last gap", round off the product family's range.

The SafetyRespect Lift Shaft Gate can be installed from the outside as well as from the inside, with the aid of the fixing brackets and hanging tubes. The upper half of the door can be opened separately, e.g. to allow tools to be handed in.

The built-in triangular lock prevents uninvited access to the inside of the shaft, yet the intelligent design allows the entire door to be opened from the inside without a key to ensure smooth escape in case of fire or danger.

The door, which weighs less than 40 kg, can easily be adapted to the structural conditions for wider shaft openings. To do this, the filler panels are pulled up to the desired length, thus widening the Lift Shaft Gate.

The Lift Shaft Gate is the safe and versatile alternative to other shaft protections in building construction.

## Components

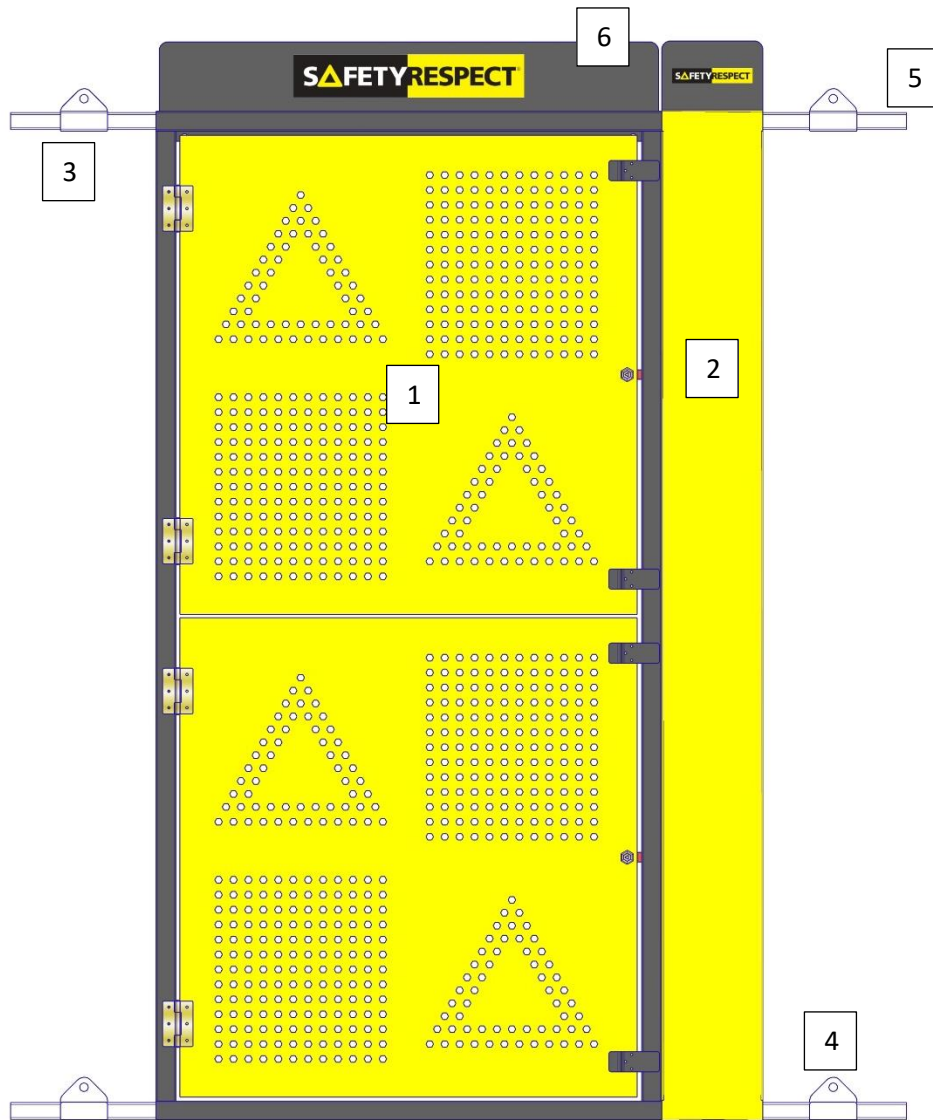

1. Lift Shaft Door
2. Panel 200/400/500
3. Upper Fixing Bracket
4. Lower Fixing Bracket
5. Hanging Tube 1500/1800/2000/3000
6. Top Panel 200/400/500/1000

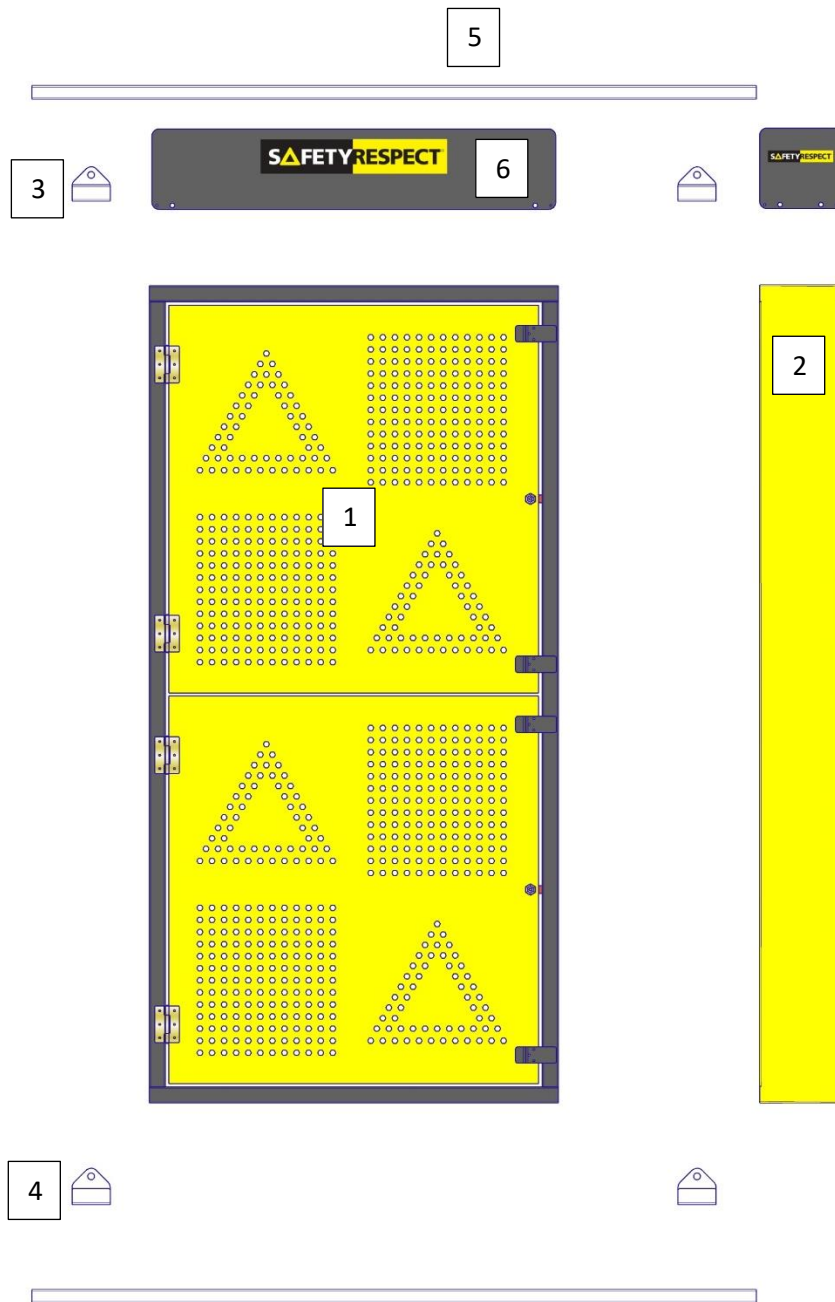

Exploded View

1. Lift Shaft Door
2. Panel 200/400/500
3. Upper Fixing Bracket
4. Lower Fixing Bracket
5. Hanging Tube 1500/1800/2000/3000
6. Top Panel 200/400/500/1000

### Fixing Brackets and Hanging Tubes

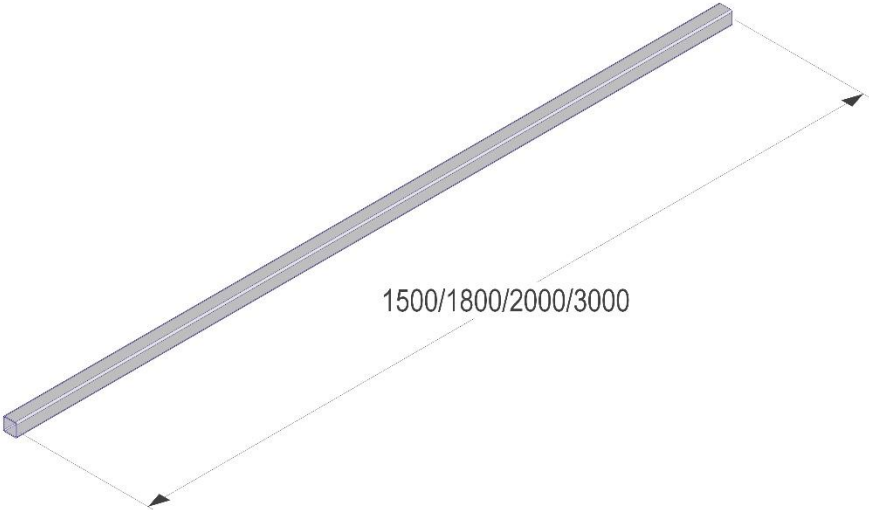
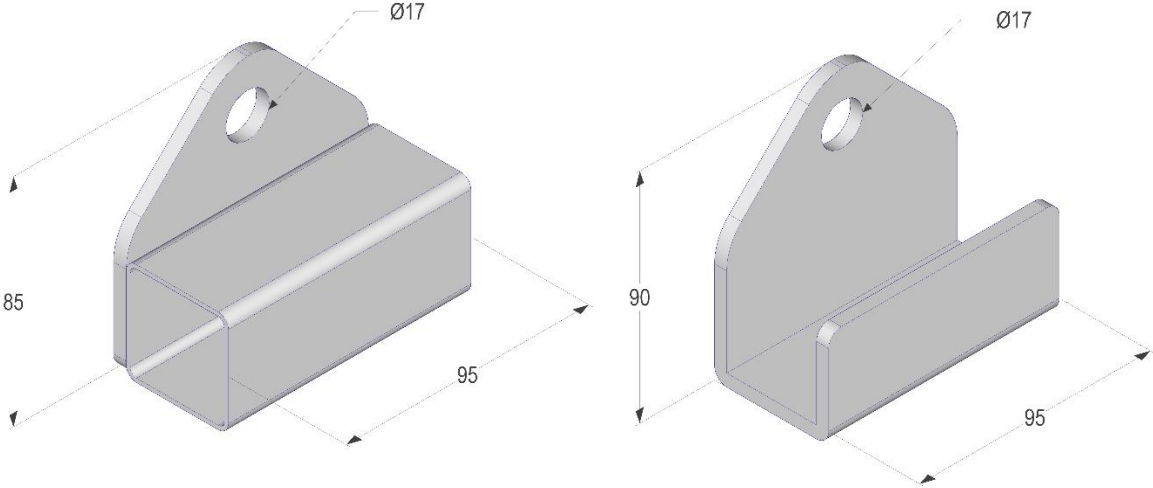

### Lift Shaft Door

2030 x 1000 mm

39 kg

Steel / powder-coated

EN 13374, class A

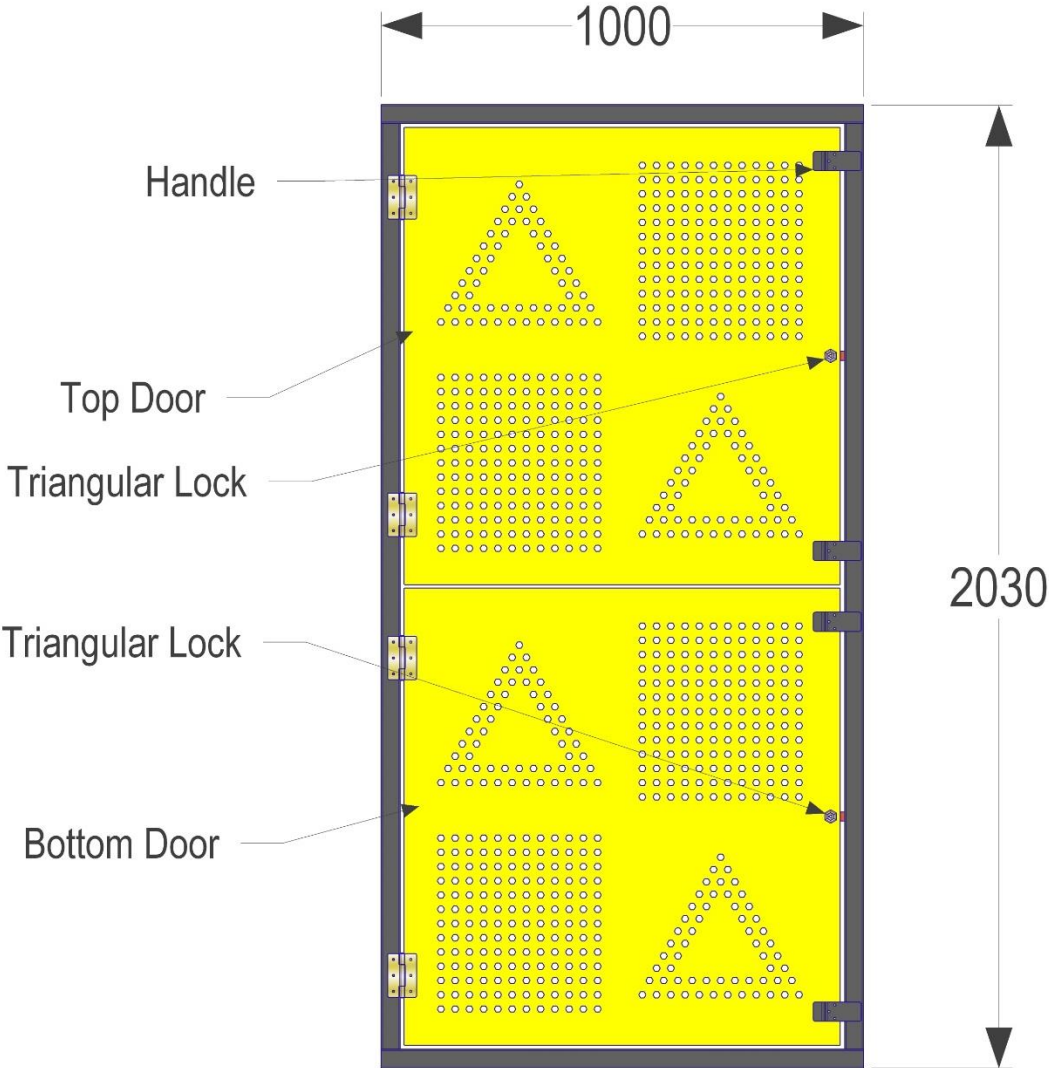

# Locking Mechanism

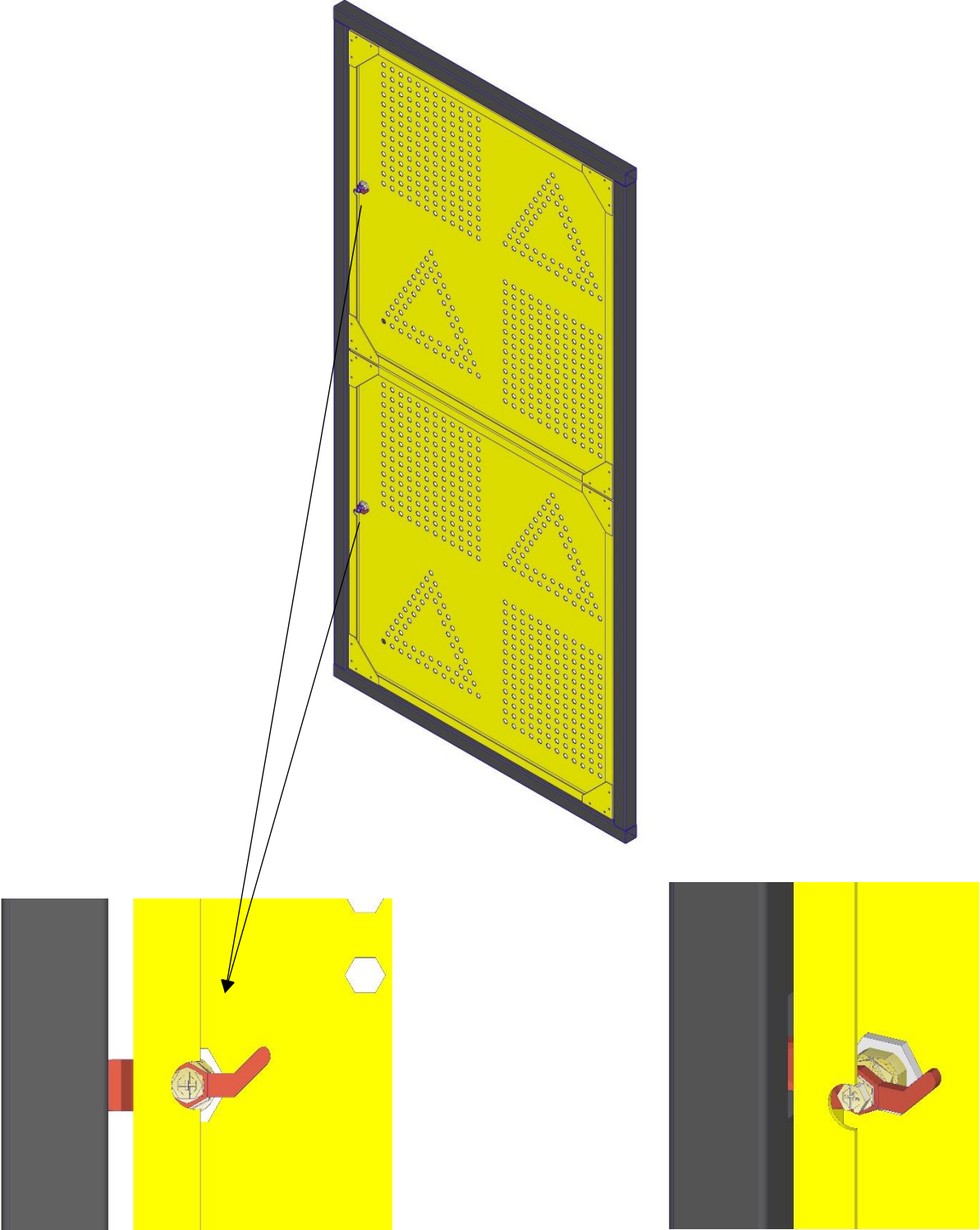



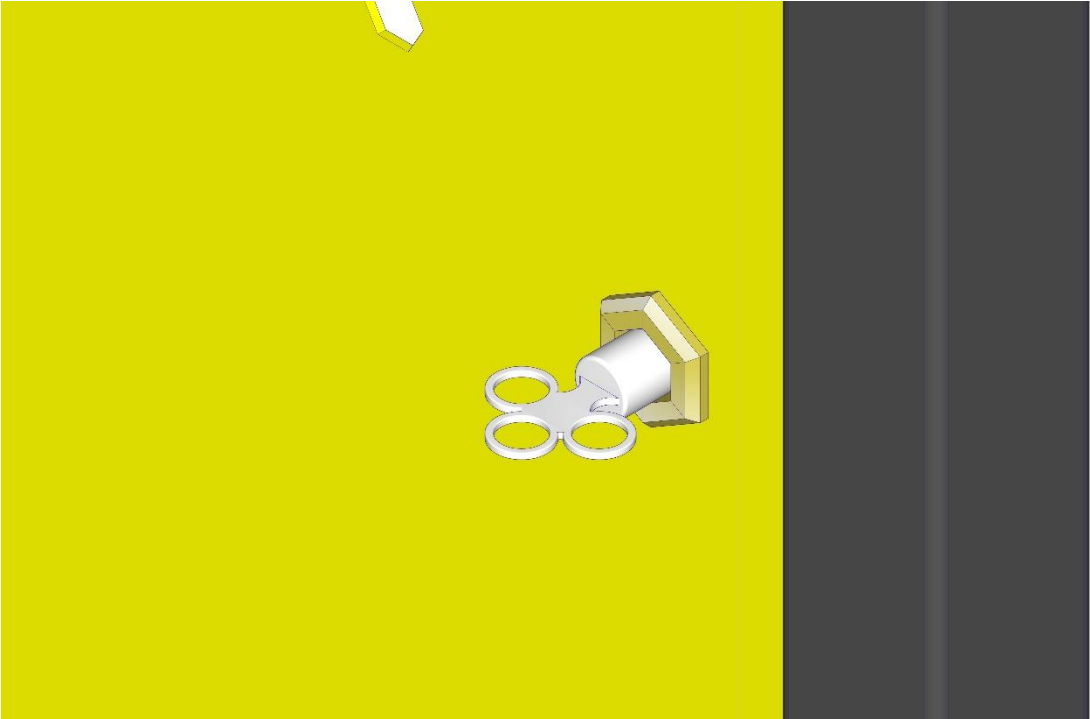
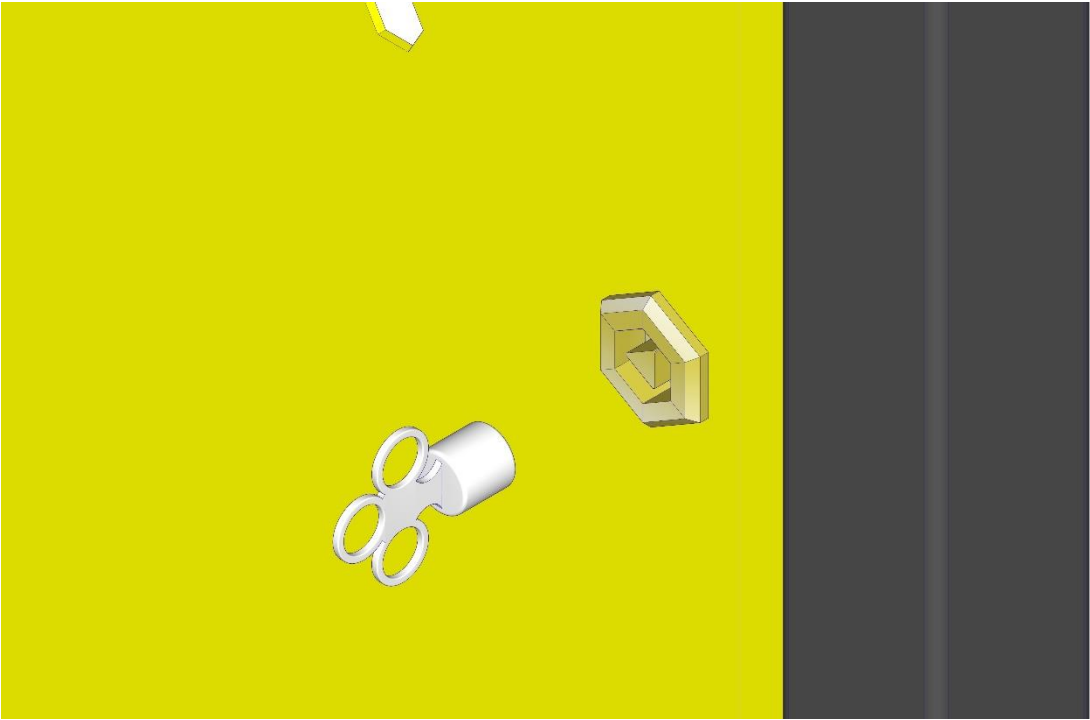

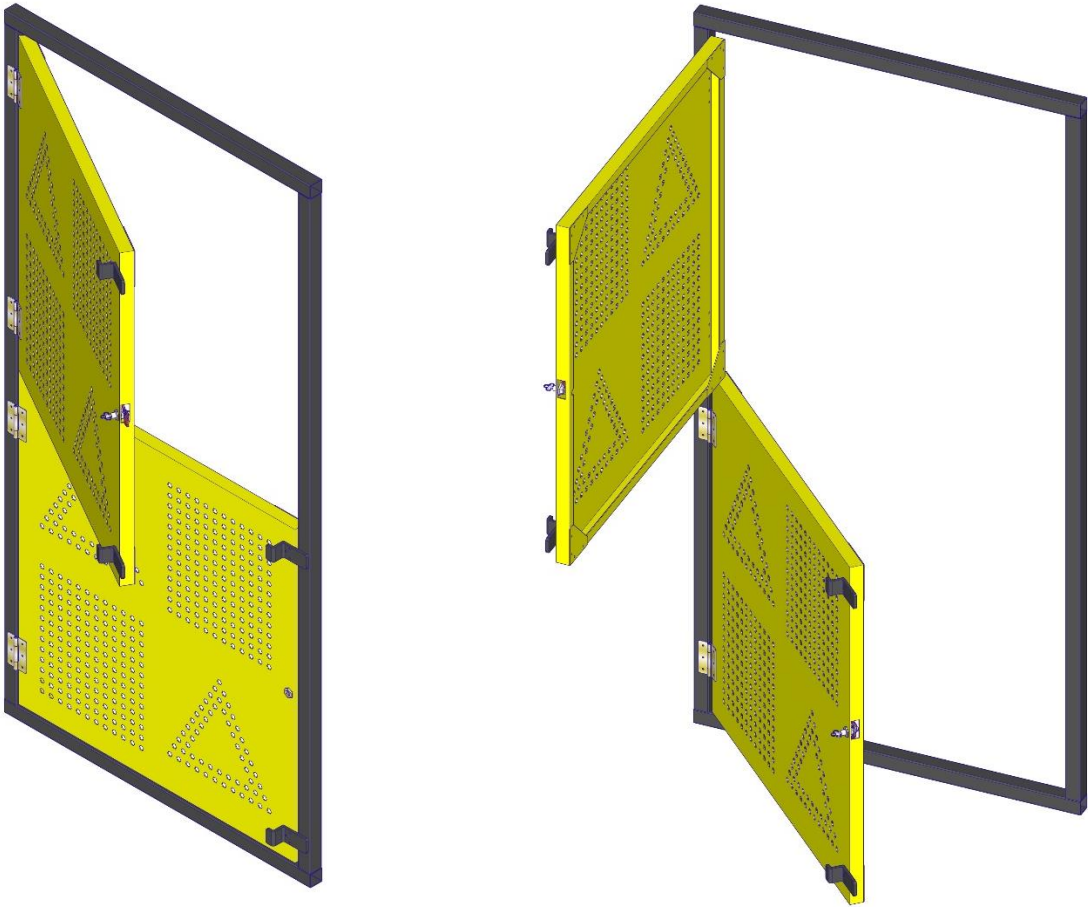
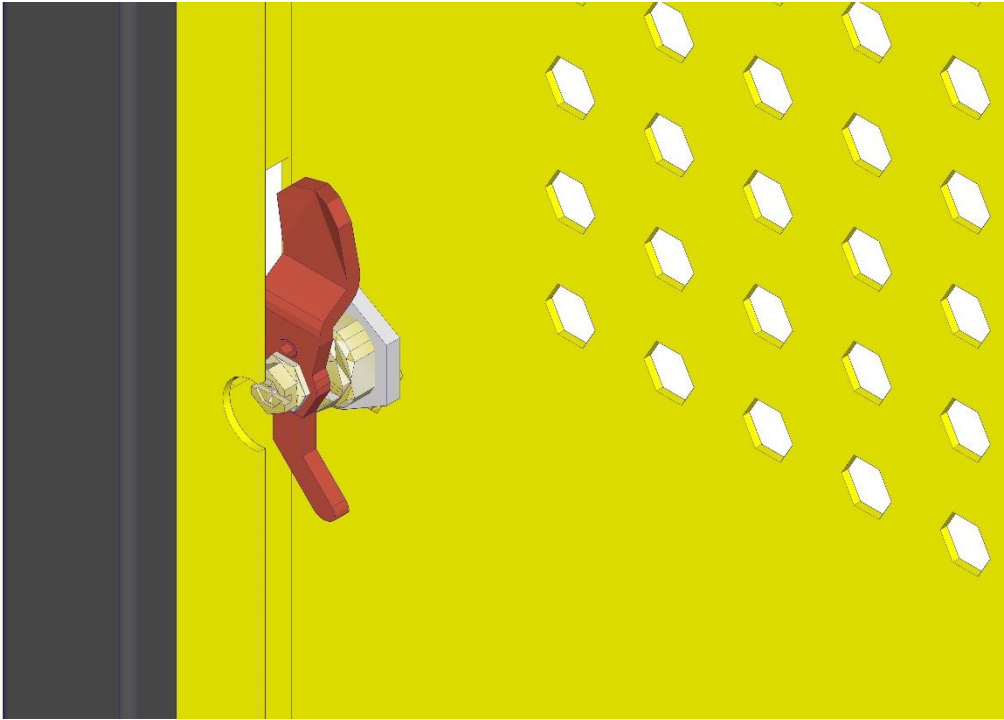

## Panel 200/400/500

2030 x 200/400/500 mm

16 kg / 24 kg / 30 kg

Steel / powder-coated

EN 13374, class A

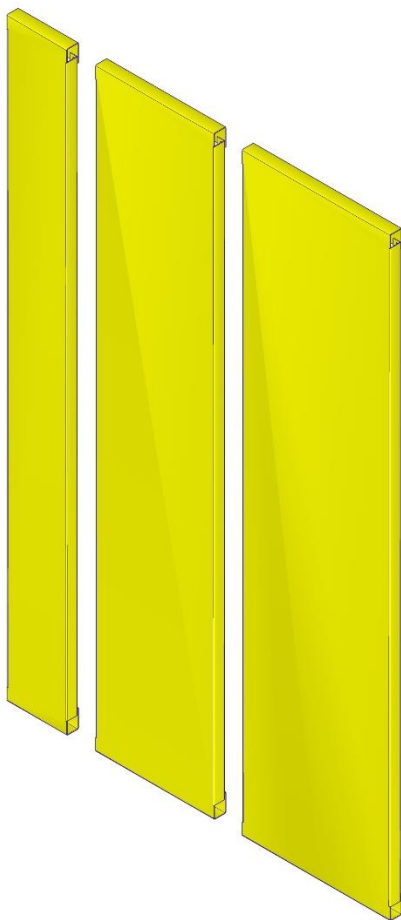

Front view

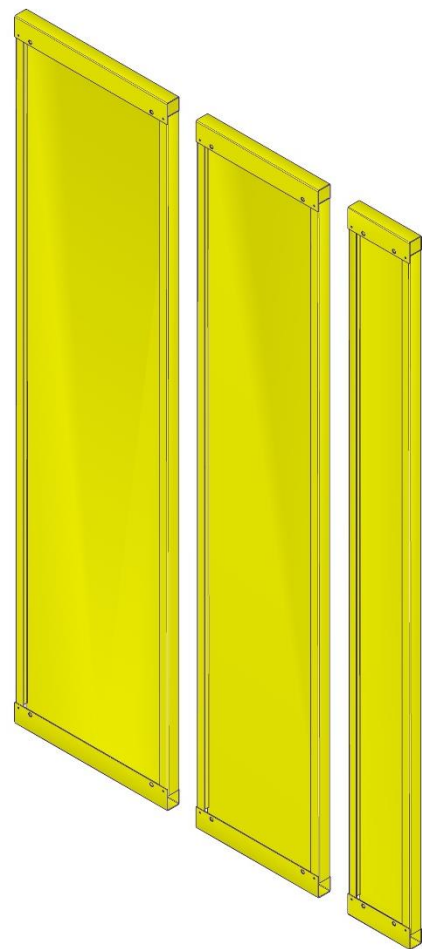

Rear view

## Top Panels

200 x 200/400/500/1000 mm

0,5 kg / 0,9 kg / 2 kg / 2,2 kg

Steel / powder-coated



## Installation

### Pre-Assembly

Fit the Lift Shaft Door and, if necessary, other filler panels onto the hanging tubes, both at the top and at the bottom.

If necessary or desired, the gap covers can also be screwed on here with conventional hexagonal screws.

Furthermore, attach the upper fixing shoes.

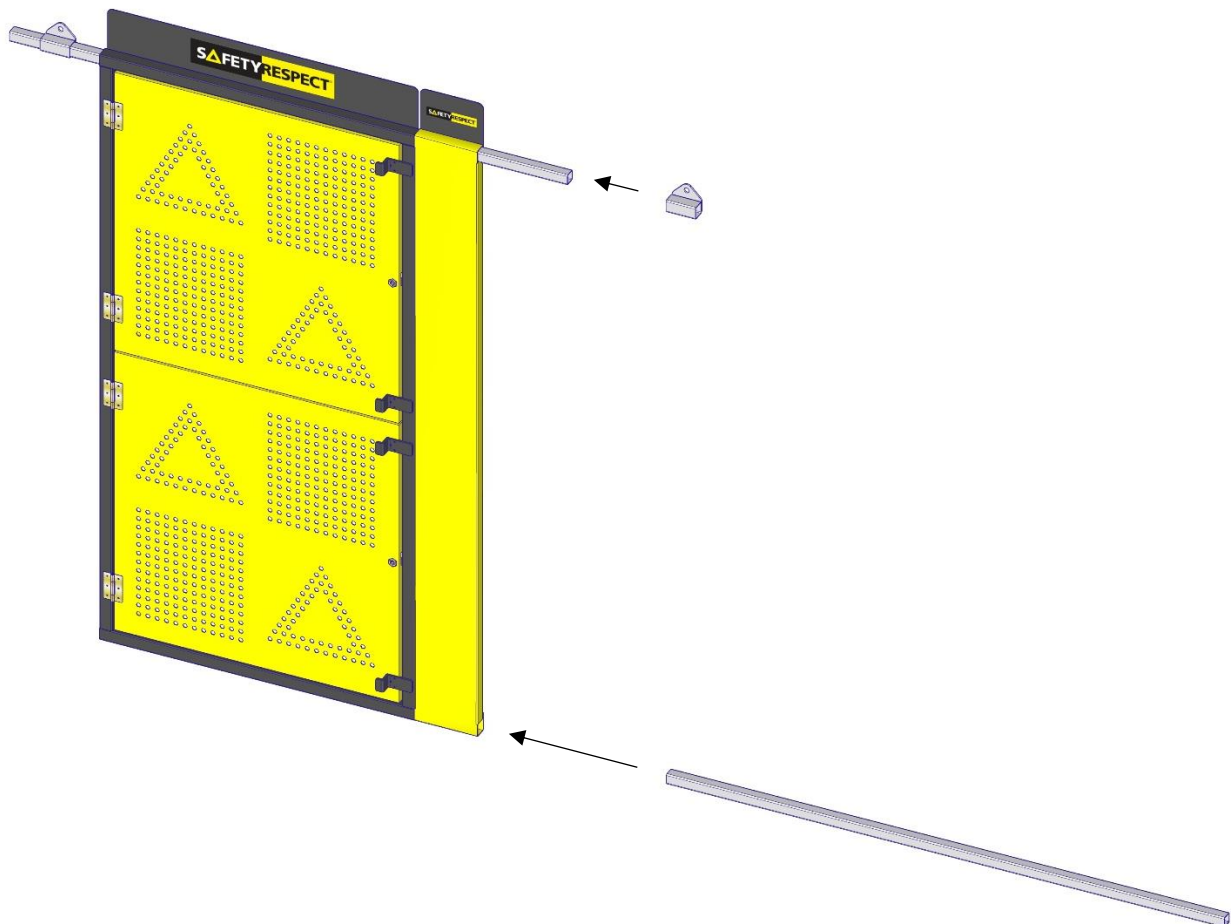

## Fixing of the Lower Fixing Brackets

Fix the Lower Fixing Brackets in the desired position in the concrete shaft. Use suitable concrete screws with min. 10 kN tensile strength.

Make sure that the fixing brackets are mounted parallel to the shaft opening.

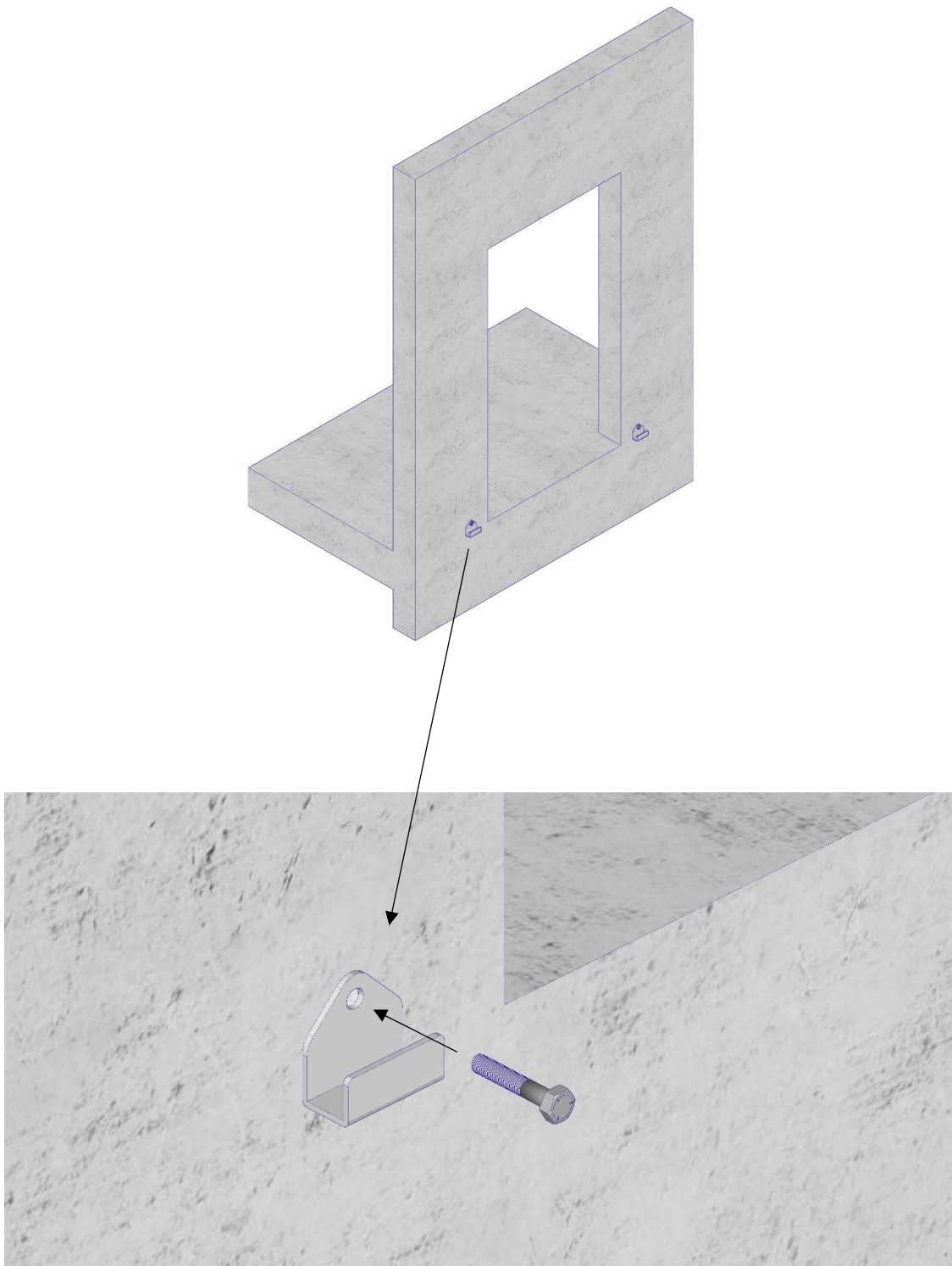

## Insertion of the Door

Insert the complete pre-assembled door unit with the Upper Fixing Brackets into the Lower Fixing Brackets.

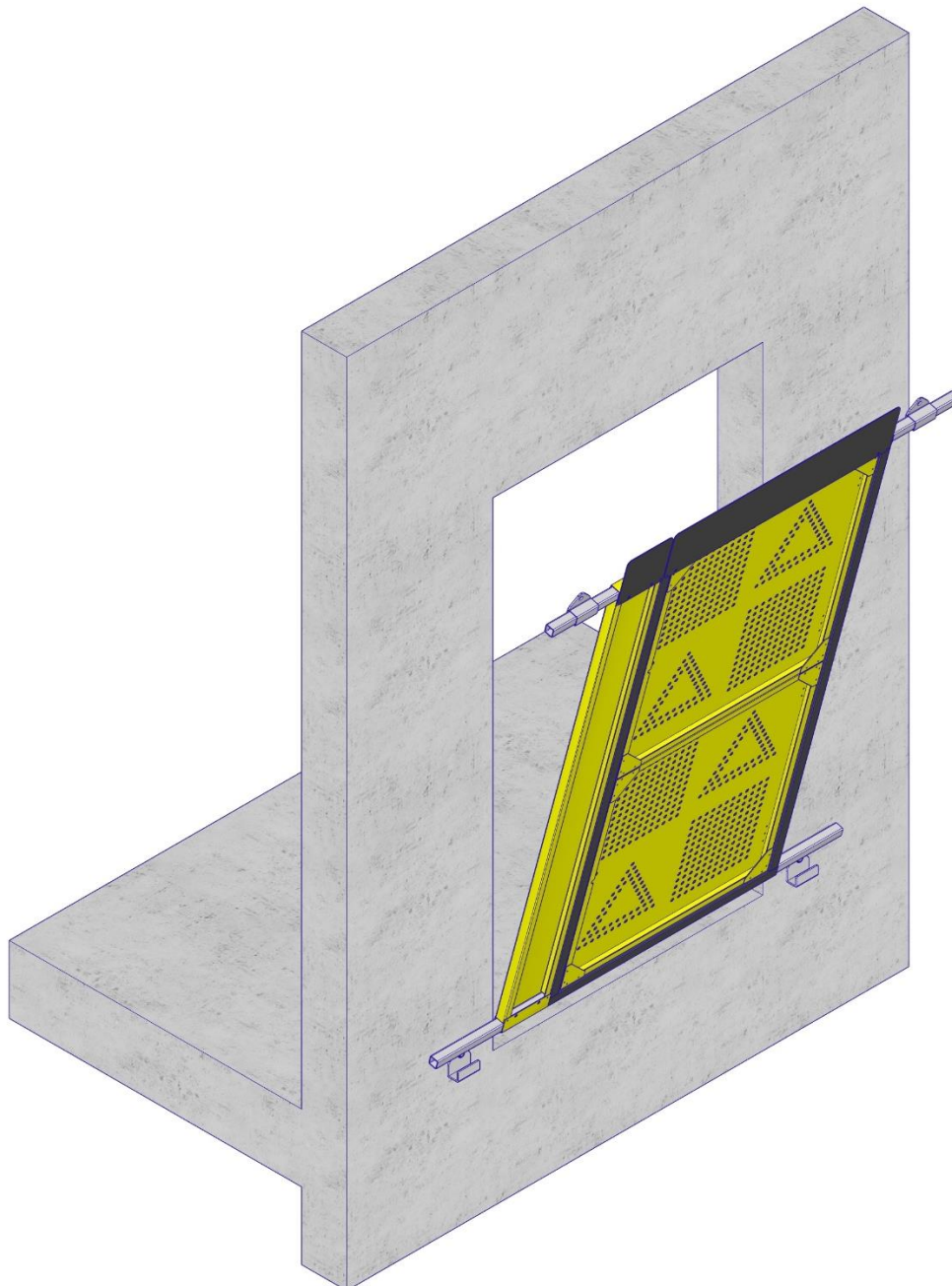



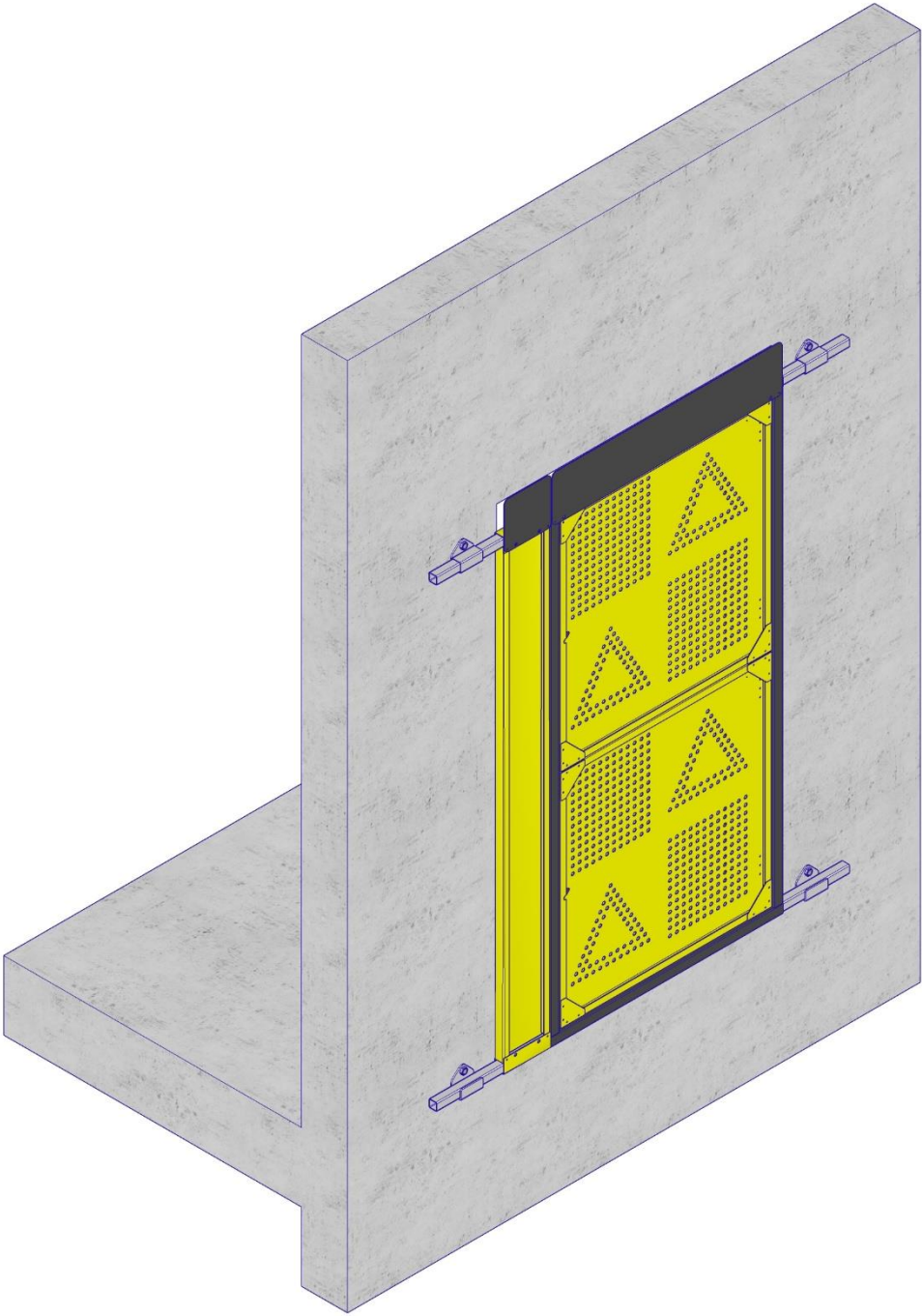



## Fixing of the Upper Fixing Brackets

Now also fix the Upper Fixing Brackets in the concrete. Use suitable concrete screws with min. 10 kN tensile strength.

It is advisable to measure again whether the Lift Shaft Gate is aligned straight.

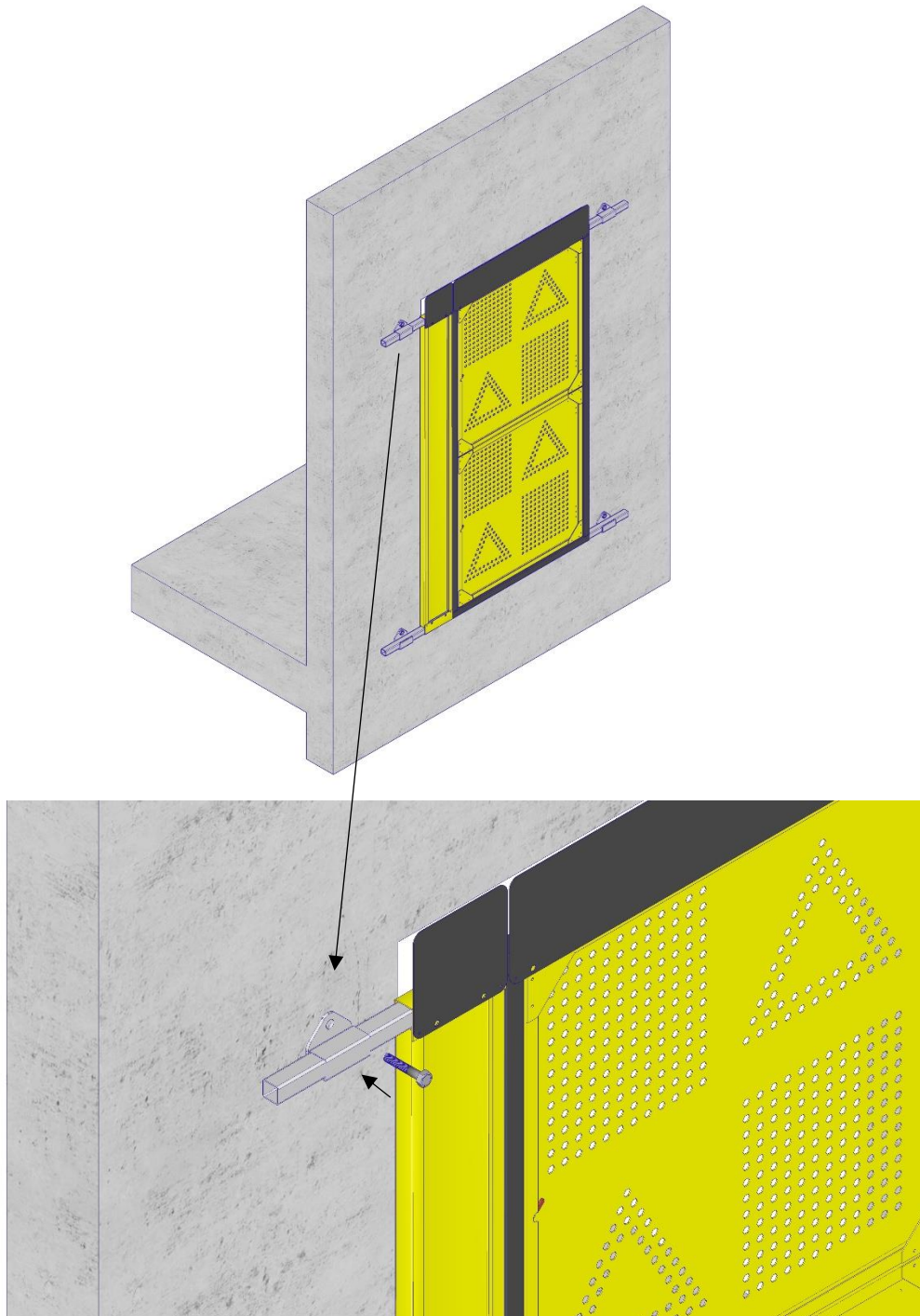

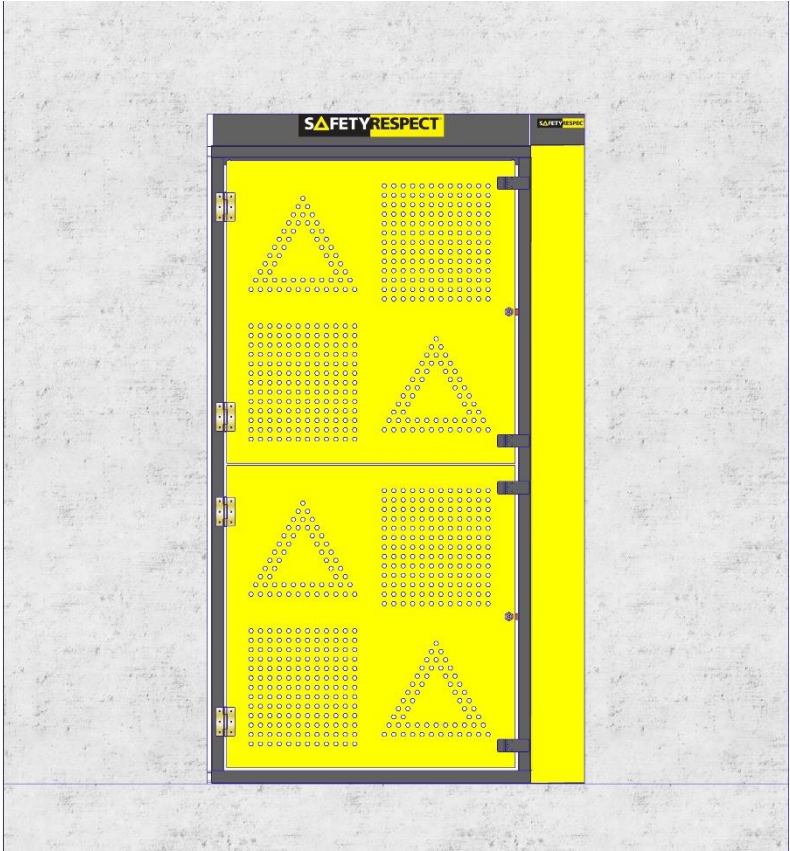

The Lift Shaft Gate can be mounted either inside or outside the shaft.

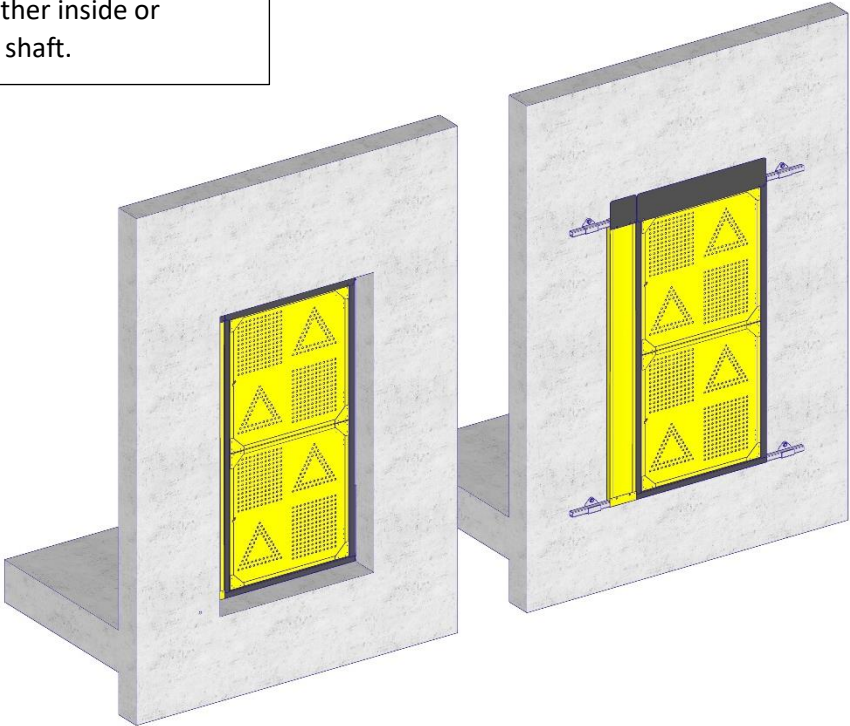

## Configurations

Width 1200 mm

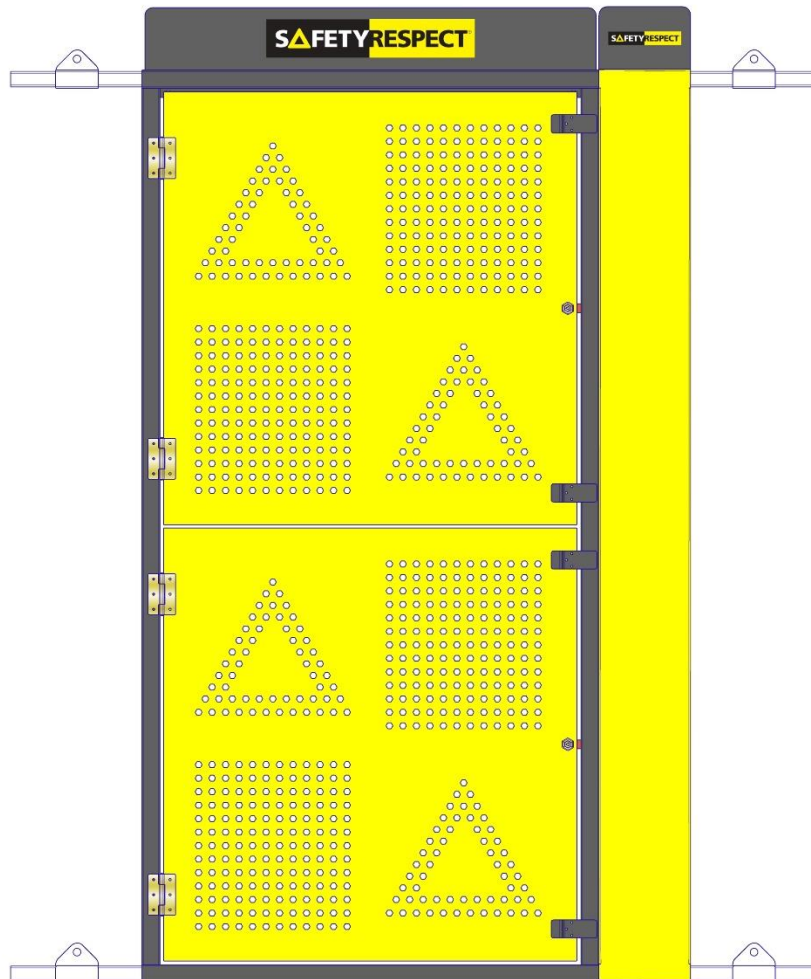

### Parts list:

- Lift Shaft Door
- Top Panel 1000 mm
- Panel 200 mm
- Top Panel 200 mm
- 2 x Hanging Tube L-1800 mm
- 2 x Upper Fixing Bracket
- 2 x Lower Fixing Bracket

Width 1400 mm

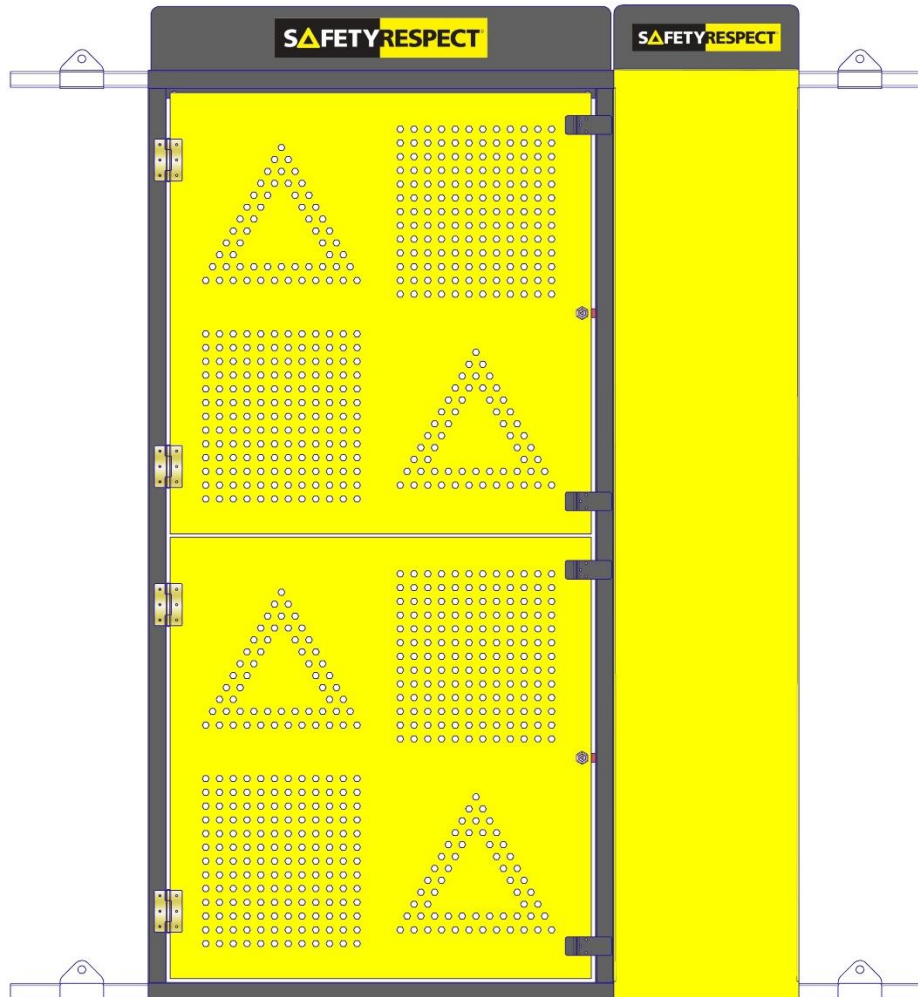

Parts list:

- Lift Shaft Door
- Top Panel 1000 mm
- Panel 400 mm
- Top Panel 400 mm
- 2 x Hanging Tube L-2000 mm
- 2 x Upper Fixing Bracket
- 2 x Lower Fixing Bracket

Width 1500 mm

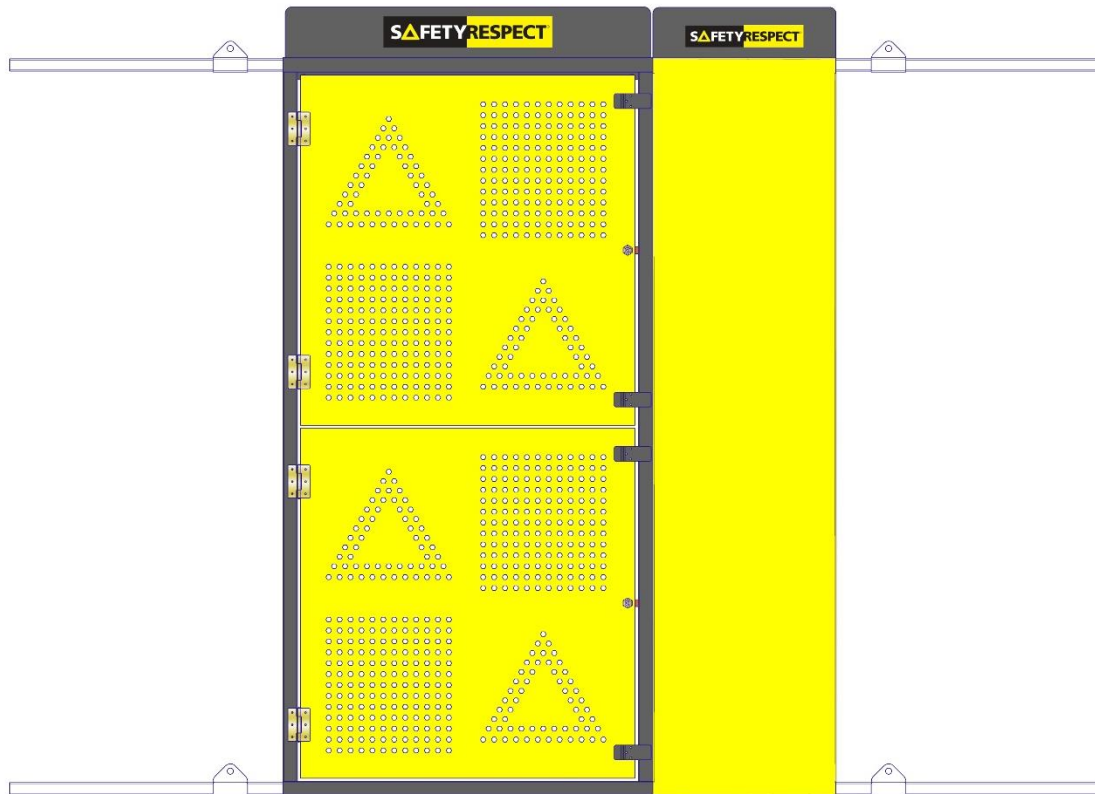

Parts list:

- Lift Shaft Door
- Top Panel 1000 mm
- Panel 500 mm
- Top Panel 500 mm
- 2 x Hanging Tube L-3000 mm
- 2 x Upper Fixing Bracket
- 2 x Lower Fixing Bracket



Width 2000 mm

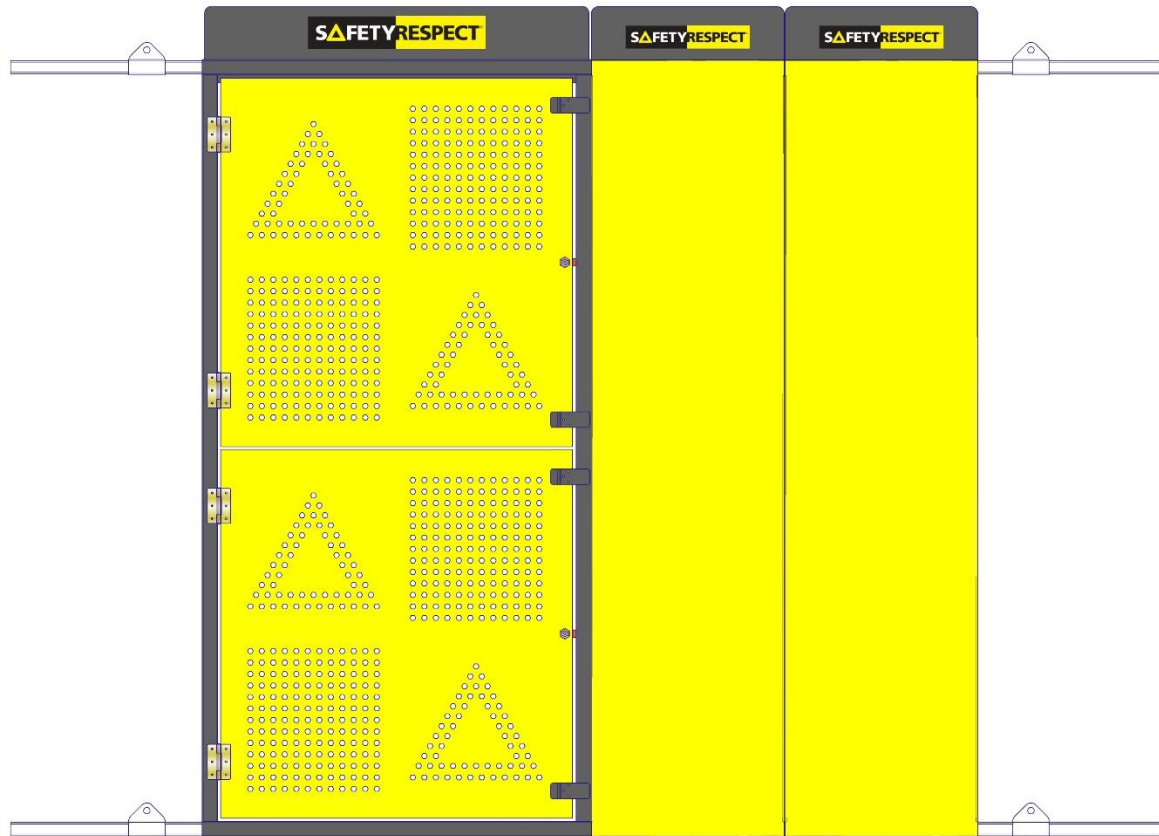

Parts list:

- Lift Shaft Door
- Top Panel 1000 mm
- 2 x Panel 500 mm
- 2 x Top Panel 500 mm
- 2 x Hanging Tube L-3000 mm
- 2 x Upper Fixing Bracket
- 2 x Lower Fixing Bracket

Width 2200 mm

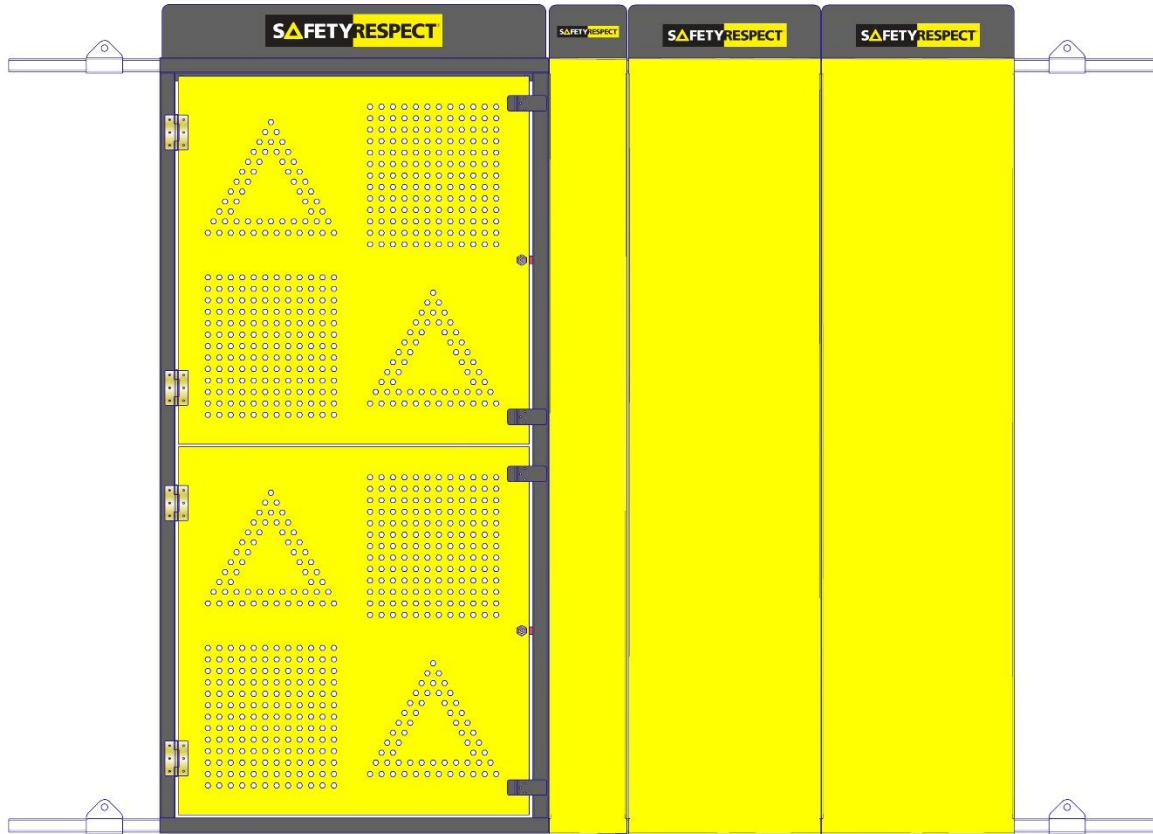

Parts list:

- Lift Shaft Door
- Top Panel 1000 mm
- 1 x Panel 200 mm
- 1 x Top Panel 200 mm
- 2 x Panel 500 mm
- 2 x Top Panel 500 mm
- 2 x Hanging Tube L-3000 mm
- 2 x Upper Fixing Bracket
- 2 x Lower Fixing Bracket

---

## Safety

When mounting all SafetyRespect edge protection components, it is essential to pay attention to safety. The maximum load of the individual components must always be kept in mind.

If a product shows significant damage that affects the statics, it must be taken out of service immediately.

Before each use, special attention must be paid to intrinsic safety. Legal regulations and guidelines of the local authorities must be observed.

It is strongly recommended to wear suitable gloves, safety shoes and a helmet during the entire assembly process to effectively prevent accident hazards. Personal protective equipment and height safety devices are recommended during assembly. Here too, the applicable regulations must be observed.

The products and tools etc. must be checked before each use. Damaged, deformed or otherwise impaired components must not be used as this may impair safety.

Putting together and combining edge protection products from different manufacturers is expressly not recommended by SafetyRespect.

If the edge protection or individual edge protection components are impaired, a competent and trained person must inspect the system and, if necessary, order dismantling or replacement.

If you have any questions or are unclear, please contact SafetyRespect.



---

## Maintenance

To ensure the full functionality and durability of the SafetyRespect Lift Shaft Gate, care must be taken. Before use, it is imperative that damaged parts are either professionally repaired by trained personnel or, in the event of significant damage, professionally disposed of and replaced. If in doubt, consult SafetyRespect.

Deformed steel parts must not be straightened and reused. For safety reasons, bent or otherwise damaged steel parts must be replaced and not repaired.

## Inspection

Before each use, it is imperative that the Lift Shaft Gate is inspected by an instructed person for damage and deformation:

Deformed steel parts must not be straightened and reused. For safety reasons, bent or otherwise damaged steel parts must be replaced and not repaired.

At all times, all components must be carefully inspected for the following:

- cracks and dents
- deformation
- corrosion
- damage
- wear and tear
- Sharp edges
- Contamination (concrete residues, bitumen residues etc.)

## Storage

The Lift Shaft Gates and all associated components and accessories must be stored in a dry well ventilated room without being exposed to the weather or aggressive substances.

## Declaration of Conformity

We hereby declare that our Lift Shaft Gate consisting of the components

Item no. 5071201	Lift Shaft Door
Item no. 5071202 – Item no. 5071204	Panel 200 / 400 / 500
Item no. 5071209	Upper Fixing Bracket
Item no. 5071210	Lower Fixing Bracket
Item no. 5071205 – Item no. 5071208	Hanging Tube 1500 / 1800 / 2000 / 3000
Item no. 5071211 – Item no. 5071214	Top Panel 200 / 400 / 500 / 1000

complies with the requirements and guidelines of standard EN 13374, Class A for temporary edge protection systems.

A further prerequisite for the standard conformity of these components or this system is the correct assembly or use as well as the standard conformity of any components interacting with the mentioned components. The instructions for assembly and use apply in their valid form.

This product complies with the health and safety regulations of the relevant standards in the European Union.

Product Category: Temporary Edge Protection

Manufacturer: SafetyRespect GmbH

Im Kurzen Busch 11

58640 Iserlohn

Germany

Best regards,

Jan-Erik Monheimius i.V.

Product Manager

SafetyRespect GmbH

**SafetyRespect GmbH**

Im Kurzen Busch 11

58640 Iserlohn

Germany

Tel.: +49 (0) 2371 155 41-0

Fax: +49 (0) 2371 219 58 70

Mail: [info@safetyrespect.de](mailto:info@safetyrespect.de)

Web: [www.safetyrespect.de](http://www.safetyrespect.de)