











PART NO 5040007

# VT STEELFLANGE

Stålbalkstving VT | VT Stahlträgerzwinge

-  L: 730 mm
-  W: 100 mm
-  H: 240 mm
-  3,8 kg
-  Steel + Zn (hot dip galvanized)
-  EN13374 – A

-   1,24 × 0,84 × 0,97 m
-  260 kg
-  50 pcs

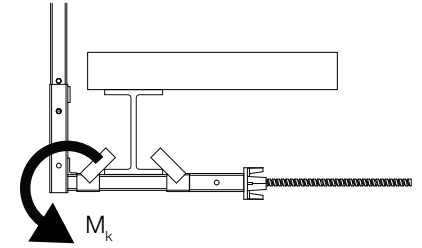
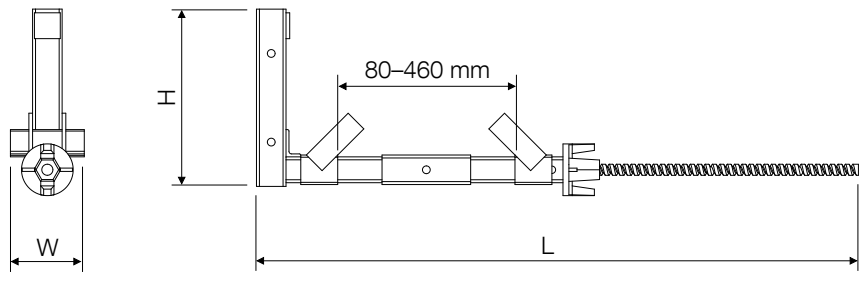
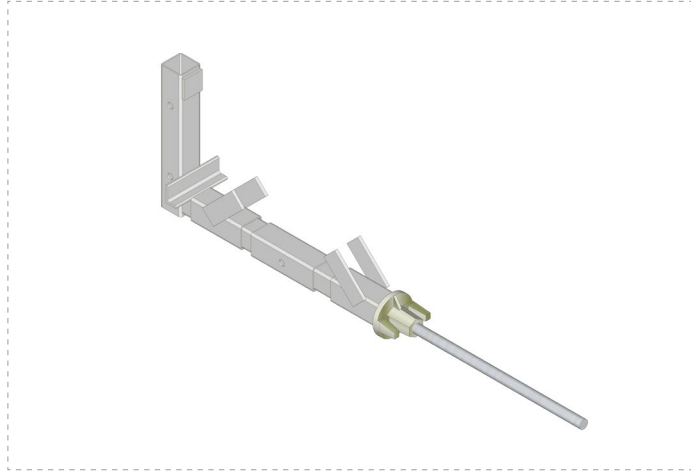

BENDING MOMENT (Q) <sup>1</sup> (Unfactored)	
M <sub>k</sub>	630 Nm
<sup>1</sup> ) Loads acc. to EN 13374:2013 $Q_{d1} \times \gamma_F^* = E_d \leq R_d = R_k / \gamma_M$ * $\gamma_F = 1,5$	

